

Competitive Cost - Highest Quality.....

PROFILE:

Durable and easy to use, our modular process drums offer an excellent method of powder handling at a reasonable cost.

Offered in many different diameters, fully customizable. Available with smooth walls or ribs (swages). Capacities range from 1 liter upwards.

Combine with our stainless steel funnels, dollies, dust-free transfer ports, discharge stations and lifting equipment for a total handling system.

FEATURES:

- Seamless, smooth Pharmaceutical and Food quality finishes
- One-piece over-center clamping ring
- "Easy Remove" FDA/USDA quality o-ring seal
- Modular design for easy connection to our filling lids and funnels
- Made for our in-drum blending system to handle all your tumble blended products



DRUM DISCHARGE STANDS



STATIONARY DRUM HANDLING SYSTEMS

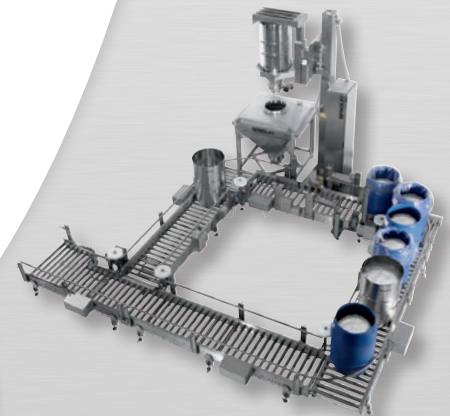

DRUM FUNNELS



DRUM BLENDING SYSTEMS



MOBILE DRUM HANDLING SYSTEMS



STACKABLE LIDDED DRUMS:

The drums are stackable on their lids, provided bottom "A" or "B" is taken. (see illustrations below) or can be provided with several different types of non-stackable bottoms which are also shown below.

All drums are available in 316-L stainless steel (304 for our food customers) and feature our "easy-remove" O-Ring design in the lid. The O-ring comes standard in silicone to FDA CFR 177.2600.

Finishing is supplied to any range, from mill finish specified Ra values with profilometer proofing. We can also recommend a finish based on your application. Additionally, our factory specializes in electro-polishing, which they do in house.



| Liters | Ø D | H | H1 | H2 | Bottom | N | Border | H3 | Model # |
|--------|--------|--------|--------|--------|-----------|---|--------|--------|---------|
| 0.5 | 4.72" | 2.6" | - | 2.8" | B | 0 | 0.35" | - | - |
| 1 | 4.72" | 4.2" | - | 4.41" | B | 0 | 0.35" | - | - |
| 1.5 | 6.69" | 2.79" | - | 2.99" | B | 0 | 0.32" | - | 403293 |
| 2 | 7.09" | 4.25" | - | 4.45" | B | 0 | 0.33" | - | - |
| 3 | 7.09" | 5.32" | - | 5.52" | B | 0 | 0.33" | - | 400501 |
| 5 | 7.09" | 9.84" | - | 10.04" | B | 0 | 0.33" | - | 400502 |
| 3 | 9.84" | 2.95" | - | 3.15" | B | 0 | 0.35" | - | - |
| 5 | 9.84" | 4.92" | - | 5.12" | B | 0 | 0.35" | - | 403294 |
| 10 | 9.84" | 8.66" | - | 8.86" | B | 0 | 0.35" | - | 403121 |
| 20 | 12.4" | 11.02" | 8.86" | 11.22" | A - B - C | 0 | 0.37" | - | 401208 |
| 30 | 12.4" | 17.10" | 14.96" | 17.32" | A - B - C | 0 | 0.37" | - | - |
| 35 | 12.4" | 19.09" | 16.93" | 19.29" | A - B - C | 0 | 0.37" | - | 401289 |
| 30 | 13.86" | 17.78" | 12.96" | 13.98" | B | 0 | 0.44" | - | - |
| 50 | 13.86" | 21.48" | 20.67" | 21.65" | B | 0 | 0.44" | - | - |
| 50 | 14.76" | 19.69" | 17.52" | 19.88" | A - B | 0 | 0.35" | - | - |
| 75 | 14.76" | 28.54" | 26.38" | 28.74" | A - B | 0 | 0.35" | - | - |
| 50 | 15.75" | 17.91" | 15.75" | 18.11" | A - B - C | 0 | 0.37" | - | 401290 |
| 75 | 15.75" | 25.20" | 23.03" | 25.39" | A - B - C | 0 | 0.37" | 8.00" | 401291 |
| 100 | 15.75" | 34.25" | 32.09" | 34.45" | A - B - C | 0 | 0.37" | 12.64" | 401292 |
| 50 | 17.75" | 14.57" | 12.41" | 14.76" | A - B - C | 0 | 0.43" | - | 406143 |
| 75 | 17.75" | 19.88" | 17.75" | 20.08" | A - B - C | 0 | 0.43" | - | 401294 |
| 100 | 17.75" | 25.98" | 23.82" | 26.18" | A - B - C | 0 | 0.43" | 8.50" | 401295 |
| 100 | 19.69" | 20.87" | 18.70" | 21.06" | A - B - C | 0 | 0.37" | 5.94" | 401355 |
| 150 | 19.69" | 30.91" | 28.74" | 31.10" | A - B - C | 0 | 0.37" | 11.26" | 401298 |
| 100 | 22.05" | 17.75" | 15.55" | 17.91" | A - C | 0 | 0.37" | - | 401259 |
| 150 | 22.05" | 25.98" | 23.82" | 26.18" | A - C | 2 | 0.37" | 8.50" | 401300 |
| 200 | 22.05" | 34.65" | 32.48" | 34.84" | A - C | 2 | 0.37" | 12.83" | 401301 |
| 260 | 22.05" | 40.95" | 37.78" | 41.14" | A - C | 4 | 0.37" | 15.98" | 40076 |

BASE OPTIONS

We offer two other standard base types or can provide a custom base to meet your exact requirements

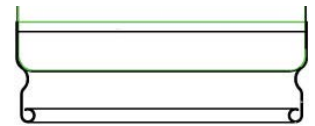

Skirt

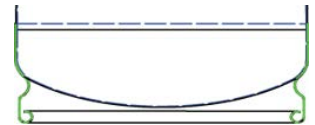

Concave w/skirt

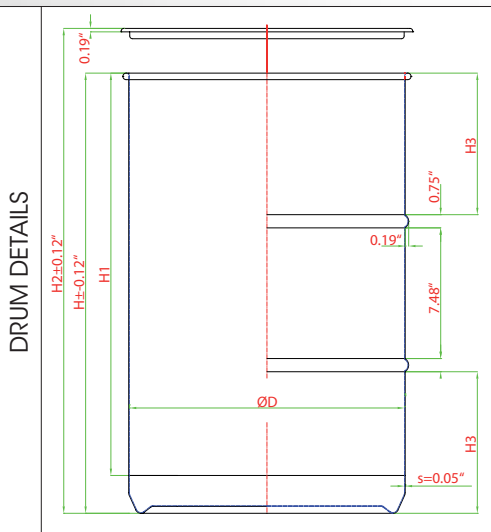

- * All drums come with or without swages (smooth walled).
- * N= number of swages (ribs) as standard

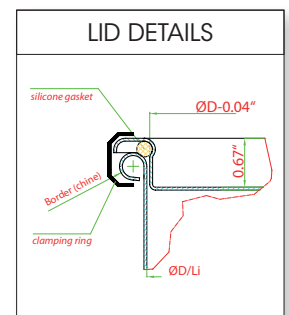
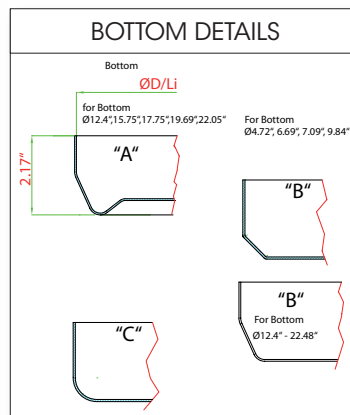

CONICAL STACKING LIDDED DRUMS:

A space saving solution: The drums are stackable, one inside the other, allowing the collection of many drums into a smaller package for easier post-usage handling.

Our Conical Drums are available in 316-L stainless steel (304 for our food customers) and feature our "easy-remove" O-Ring design in the lid. The O-ring comes standard in silicone to FDA CFR 177.2600.

Finishing is supplied to any range, from mill finish specified Ra values with profilometer proofing. We can also recommend a finish based on your application. Additionally, our factory specializes in electro-polishing, which they do in house.

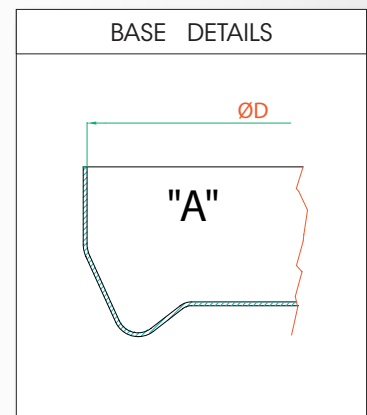
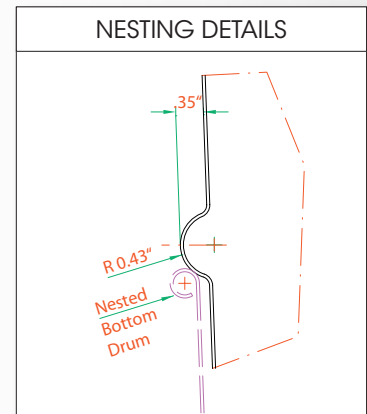
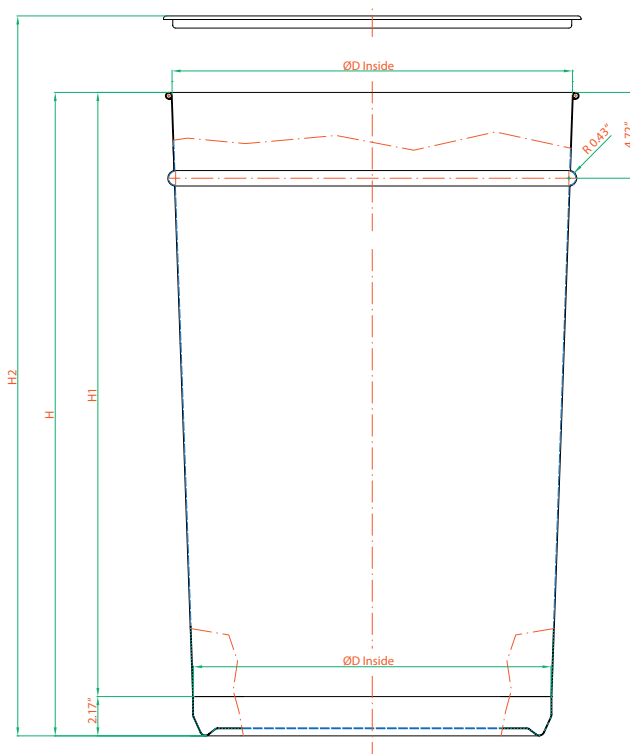

| Liters | Ø D | H | H1 | H2 | Bottom | Border | Model # |
|--------|-----------------|--------|--------|--------|-----------|--------|---------|
| 50 | 12.40" / 14.76" | 22.24" | 20.08" | 22.44" | A - B - C | 0.35" | 4004231 |
| 75 | 14.76" / 15.75" | 26.18" | 24.02" | 26.38" | A - B | 0.37" | 4004232 |
| 100 | 15.75" / 17.72" | 28.94" | 26.77" | 29.13" | A - B - C | 0.43" | 4004233 |
| 120 | 17.72" / 19.69" | 27.76" | 25.59" | 27.95" | A - B - C | 0.35" | 4004234 |
| 150 | 19.69" / 22.05" | 27.36" | 25.20" | 27.56" | A - B - C | 0.35" | 4004235 |
| 180 | 19.69" / 22.05" | 32.28" | 30.12" | 32.48" | A | 0.35" | 4004236 |

DRUM OPTIONS:

We offer a whole host of options from drum bases, rims, handles and bottoms

Here's a sample of common options, we can offer virtually any custom request you have, please inquire!

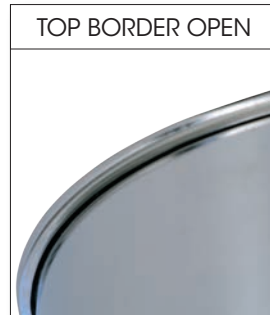
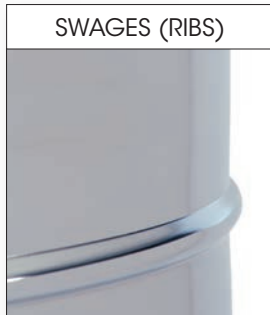
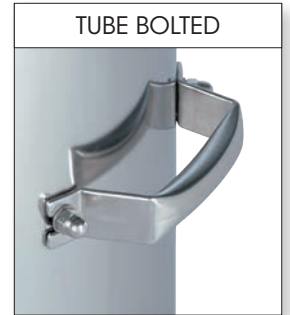

DRUM DOLLIES:

We offer 2 standard dolly types and any custom dolly for any drum

PUSH CART TYPE: Totally enclosed tubing push handle for ergonomic loading and moving. Flat table with safety slide-off lip at front. Offered for all capacities of drums. The unit features solid stainless steel construction with a #220 grit finish (GMP). Two fixed front wheels and two swivel, locking rear castors. Wheels feature non-marking materials, sealed bearings and stainless steel housings.

PAN TYPE: Pressed pan unit, designed to be an "integral" part of the drum. Ideal for processes that need maximum manoeuvrability. The units feature a solid stainless steel design with a #220 grit finish (GMP) and center water-drain hole. Five (5) swivel castors, two with break unit. Wheels feature non-marking materials, sealed bearings and stainless steel housings.

